



Shoulder Bag

Design & work: Kokka Fabric

Size: about 29cm (l)
about 40cm(w)
about 14cm(d) (excludes handles)

Materials

- Outer Fabric A: 110cm wide x 80cm
- Outer Fabric B: 50cm wide x 15cm
- Lining Fabric: 90cm wide x 80cm
- Fusible interfacing (Thick): 110cm wide x 80cm
- Magnetic clasp (hook type) : 15mm (one pair)

Fabric shown for this sample: P41500-502(A)

Pattern

Unit: Centimeters (cm)
Add 1cm seam allowance when cutting the fabric.

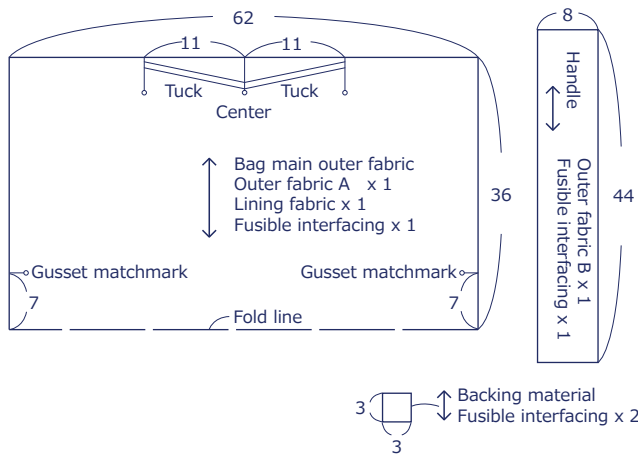

※ Adhere fusible interfacing on the back of the outer fabrics.
Backing material is for attaching the magnetic hook

have fun with KOKKA fabric! produced by **KOKKA**

kokka-fabric.com

The craft projects and works featured in kokka-fabric.com are strictly for personal use and enjoyment.
Please refrain from selling handmade items using the same exact design (including the pieces made in different fabrics) featured in kokka-fabric.com.

Instructions

1. Make the handle.

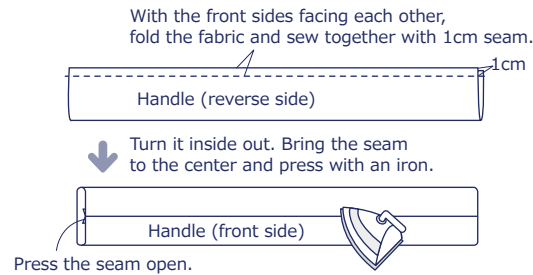

2. Sew the tucks of the bag.

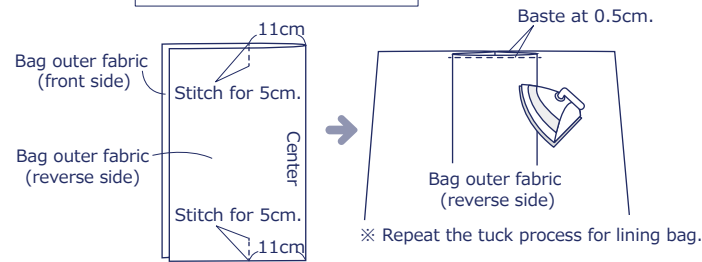

3. Attach the magnetic clasp on the bag lining fabric.

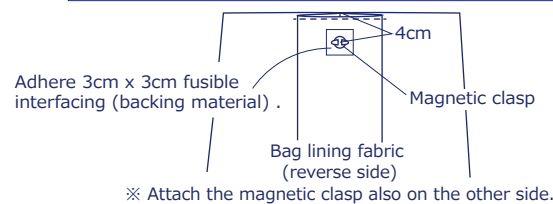

4. Fold the gusset on the side of the outer bag and sew.

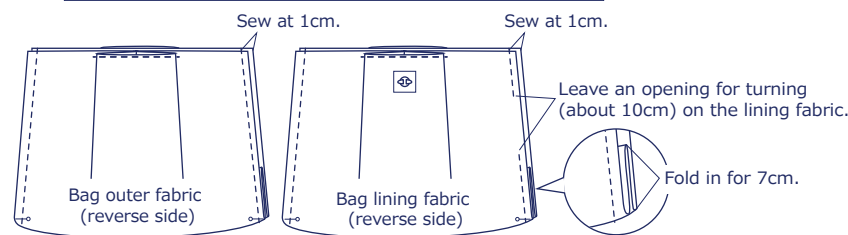

5. With the front sides facing each other, sew together the bag outer fabric and lining fabric at the opening.

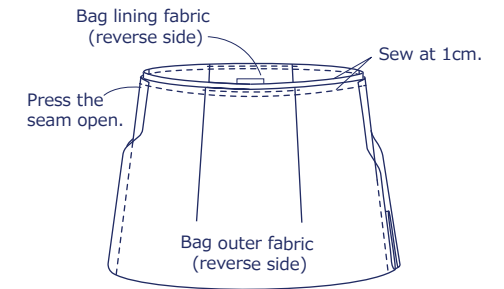

6. Using the opening for turning, turn the bag inside out and run stitches around the opening.

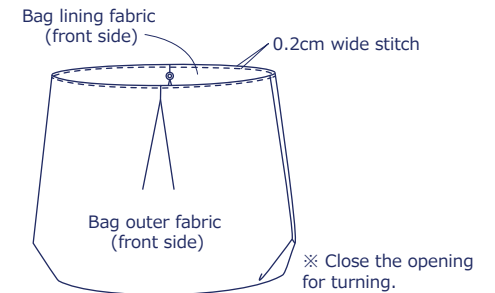

7. Attach the handle to finish.

