



Round Pouch

Design & Work: Kokka Fabric

Size: about 10cm (l) x about 14cm (w)
x about 8cm (d)

have fun with KOKKA fabric! produced by **KOKKA**

kokka-fabric.com

The craft projects and works featured in kokka-fabric.com are strictly for personal use and enjoyment. Please refrain from selling handmade items using the same exact design (including the pieces made in different fabrics) featured in kokka-fabric.com.

Materials

- Outer Fabric: 110cm wide x 20cm
- Lining Fabric: 110cm wide x 20cm
- Fusible interfacing: 90cm wide x 20cm
- Zipper (20cm): One piece

Fabric shown for this sample: YJ71030-2C

Pattern

Unit: centimeters (cm). []: seam allowance.
All seam allowances 1cm unless otherwise stated.

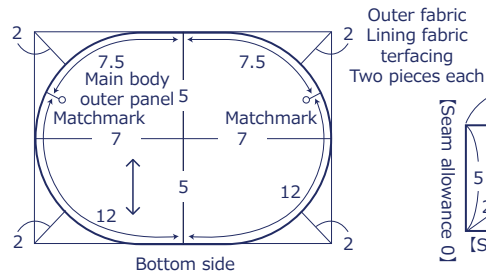
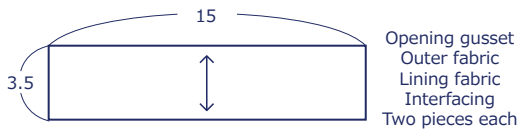
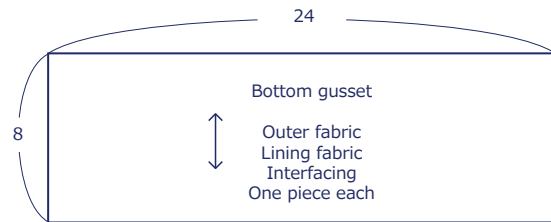

Instructions

1. Attach interfacing on the back of the outer fabrics of main body panel fabric, opening gusset and bottom gusset.

2. Attach a zipper to the outer opening gusset.

Fold the seam allowance of the opening where zipper is attached. Layer it with the zipper and sew together.

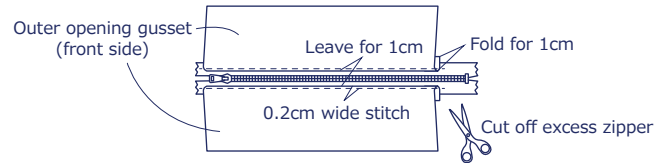

3. Make a tab. Fold in half and baste it to the outer opening gusset.

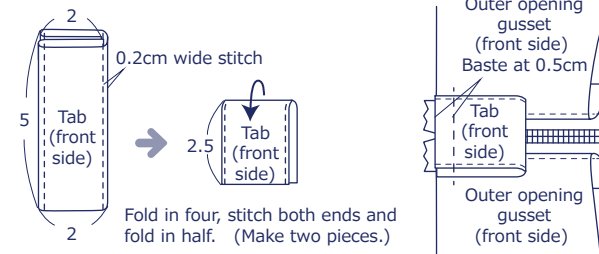

4. With the front sides facing each other, sew together the outer opening gusset and outer bottom gusset.

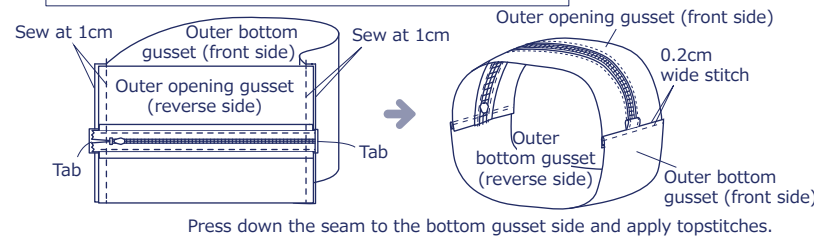

5. With the front sides facing each other, sew together the lining opening gusset and lining bottom gusset.

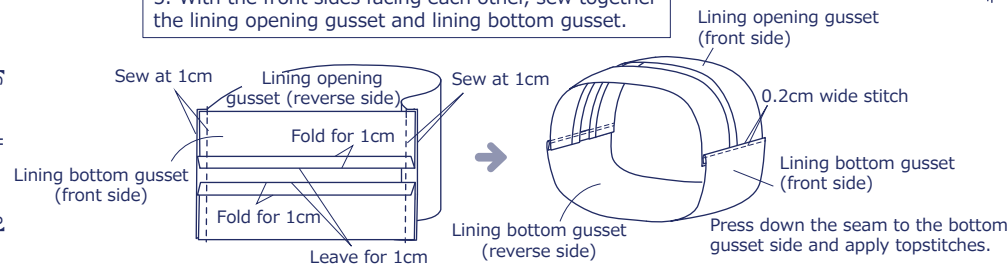

6. With the front sides facing each other, sew together the main body and gussets.

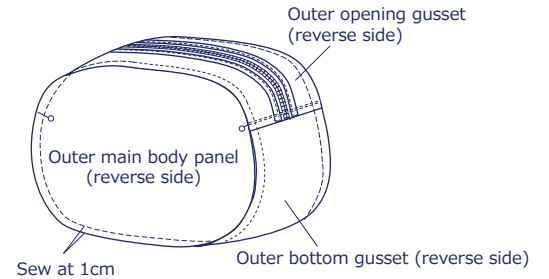

* Repeat the process and sew together the lining main body.

7. With the front sides of the outer fabric and lining fabric facing outside, sew together the zipper and lining fabric at the top opening using blind stitches.

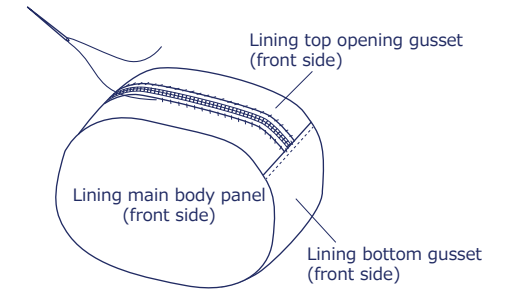

8. Turn it inside out to finish.

Put 35cm satin ribbon through the hole of the zipper pull and tie a knot.

