

The craft projects and works featured in kokka-fabric.com are strictly for personal use and enjoyment. Please refrain from selling handmade items using the same exact design (including the pieces made in different fabrics) featured in kokka-fabric.com.



Three Piece Set from 60cm Panel Fabric

Design & work: Kokka Fabric

Size: (Tote Bag) About 27cm (l) About 27cm (w) (Handles excluded)
 (Pouch) About 13cm (l) About 21cm (w)
 (Clutch Bag) About 27cm (l) About 23cm (w) (Handles excluded)

Materials

- Outer Fabric: 110cm wide×60cm
- Lining Fabric: 110cm wide×60cm
- Fusible Interfacing (Heavy weight): 110cm wide×60cm
- Zipper: Two pieces (30cm or longer)

Fabric shown for this sample: (Outer fabric) LUCKY TYPO P47300-301B

Pattern

Unit: cm. Numbers include seam allowance.

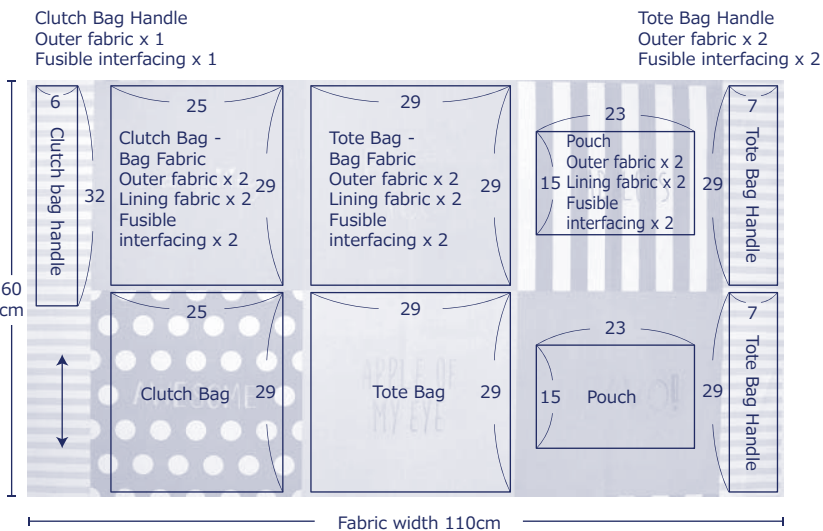

This cutting layout is one example.

※ Adhere fusible interfacing on the back of the outer fabrics.

Instructions

1. Make the handles for tote bag and clutch bag. Baste them to the bag fabrics.

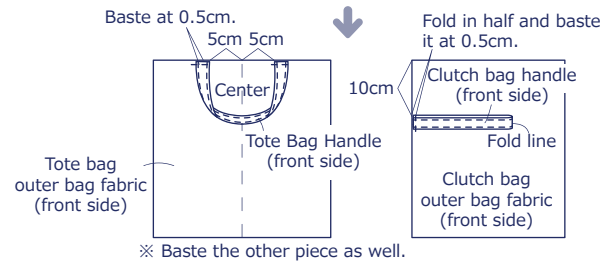
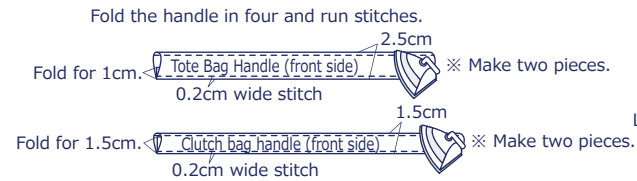

2. With the front sides facing each other, sew together the tote bag outer bag fabrics at the sides and bottom.

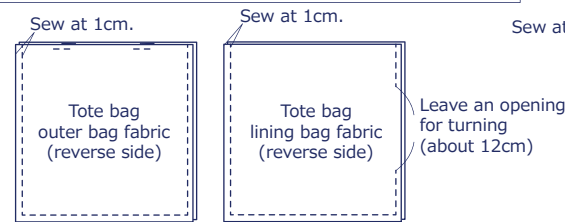

3. With the front sides facing each other, sew together the tote bag outer and lining bags at the top opening. Turn it over and run stitches at the top to finish.

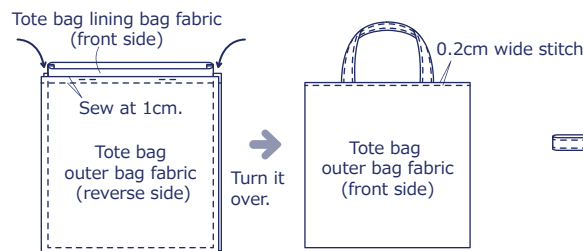

※ Close the opening for turning.

4. Attach the zipper to the clutch bag outer bag fabric and pouch outer fabric.

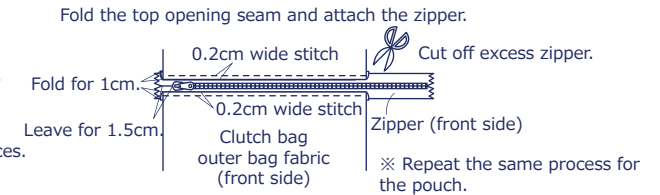

5. With the front sides facing each other, sew together the clutch bag fabrics and pouch respectively at the sides and bottom.

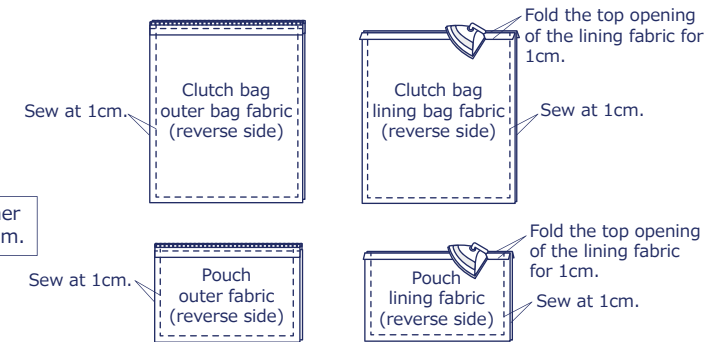

6. To finish the clutch bag and pouch, sew together the opening of the lining bag fabric and zipper using blind stitching.

