



Tote Bag with Crossed Handles

Design & Work: Kokka Fabric

Size: about 23cm (l)
about 38cm (w)
about 24cm

Materials

- Outer Fabric: about 110cm wide x 50cm
- Lining Fabric: about 100cm wide x 70cm
- Fusible Interfacing (heavy weight): about 110cm wide x 70cm

Fabric shown for this sample: LG-36010-1A

Pattern and Cutting Layout

Unit: cm [] Seam allowance
Add 1cm seam unless otherwise specified when cutting the fabric.

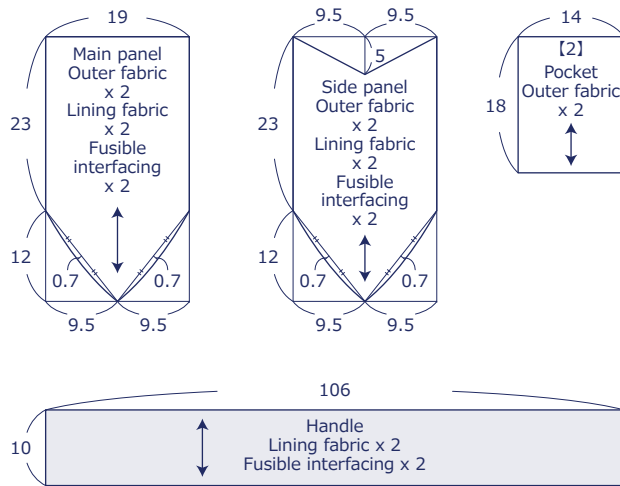

※Adhere fusible interfacing on the back of the main panel outer fabric, side panel outer fabric and handle fabric.

have fun with KOKKA fabric! produced by KOKKA

kokka-fabric.com

The craft projects and works featured in kokka-fabric.com are strictly for personal use and enjoyment. Please refrain from selling handmade items using the same exact design (including the pieces made in different fabrics) featured in kokka-fabric.com.

Instructions Front Side - (FrS), Reverse Side (RvS)

1. Make the pocket and attach it to the outer main panel

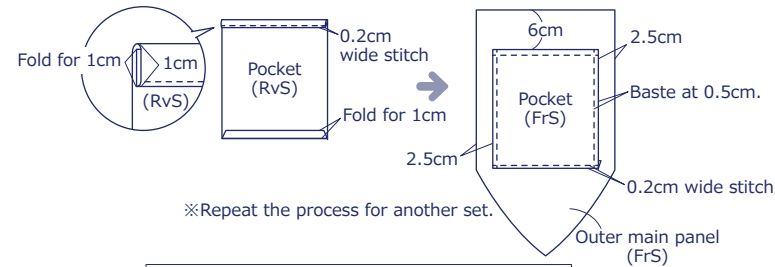

2. With the front sides facing each other, sew together the main panel and side panel

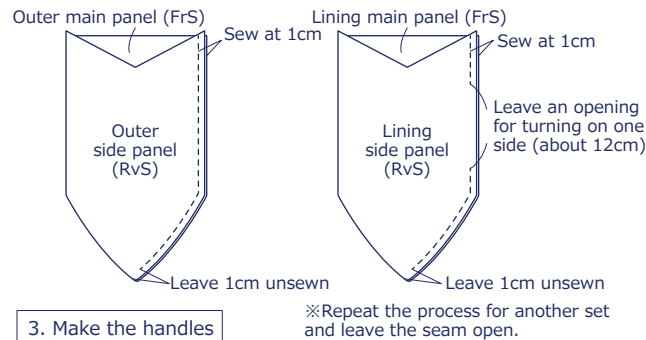

3. Make the handles

With the front sides facing each other, sew together the handle at one end. Twist around one of the strips. With the front sides facing each other, sew together the unsewn end to make a loop.

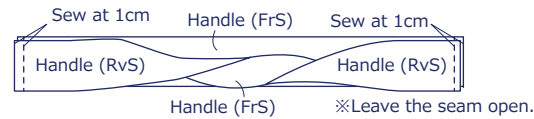

Apply stitches on the edge at the end of the process.

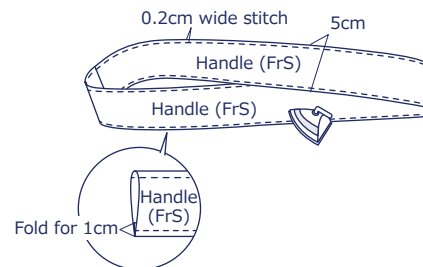

4. Attach the handles to the outer main panel

Align the seam line of the pieced outer main panel and outer side panel with the centerline of the handle. Sew together.

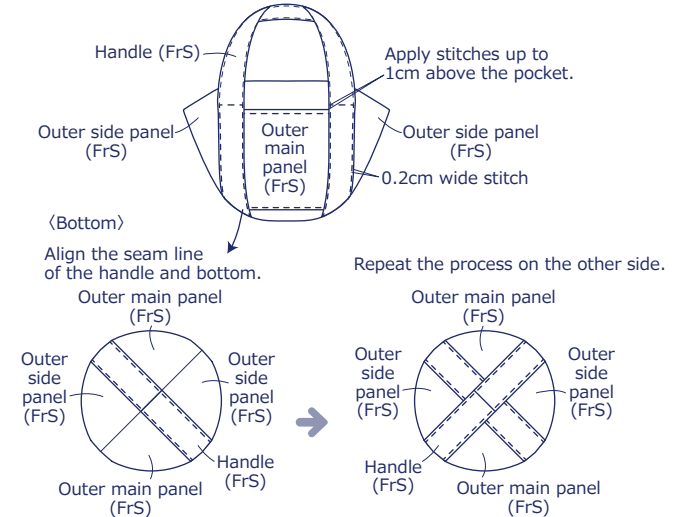

5. With the front sides facing each other, sew together the outer main bag panel and lining main bag panel at the bag opening. Turn it inside out and apply stitches around the top opening

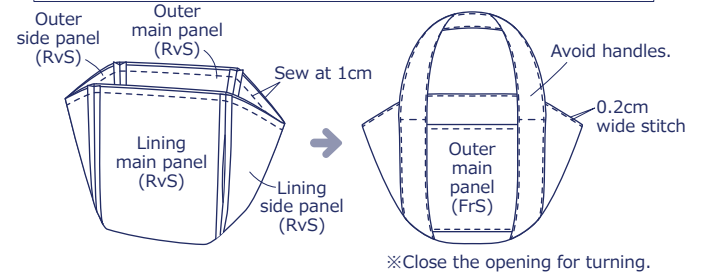

6. Fold the handle in half. Apply stitches to finish

