



Multi-Use Case

Design & work: Ayumi Yatsuta

Size: 12cSize: 18cm (l) 12cm (w) 2cm (w)

have fun with KOKKA fabric! produced by KOKKA

kokka-fabric.com

The craft projects and works featured in kokka-fabric.com are strictly for personal use and enjoyment. Please refrain from selling handmade items using the same exact design (including the pieces made in different fabrics) featured in kokka-fabric.com.

Materials

- Fabric (Outer fabric A) 50cm x 25cm (Outer fabric B, Lining fabric): 50cm x 25cm (Outer fabric C, Pen holder, Zipper tab, Bias binding strip): 50cm x 50cm (Pocket-large): 50cm x 25cm (Pocket-small): 40cm x 25cm
 - Fusible quilt batting: 30cm x 20cm □ Fusible interfacing (light weight) 60cm x 20cm
 - Fusible interfacing for bags (stiff type): 2cm x 18cm
 - Rickrack tape: 0.4cm wide x 60cm
 - Free style zipper (3VS): 90cm □ Mini ring slider: One piece
- Fabric shown for this sample: (Outer fabric A): PASTEL POP YK-76020-2A
 (Outer fabric B, Lining fabric): PASTEL POP YK-76040-2A
 (Outer fabric C, Pen holder, Zipper tab, Bias binding strip): PASTEL POP YK-76040-1C
 (Pocket-Large): PASTEL POP YK-76040-1B
 (Pocket-Small): PASTEL POP YK-76020-1A

Pattern and Cutting Layout

Unit: cm. 0.7cm seam unless otherwise specified.

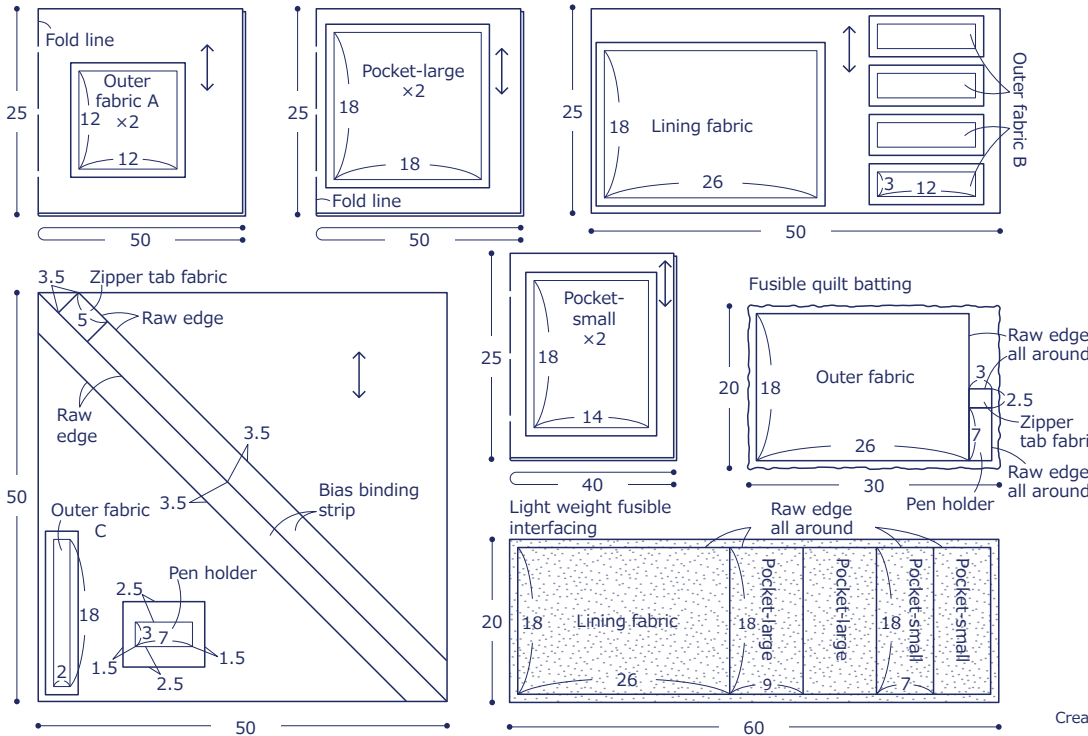

Instructions Front Side - (FrS), Reverse Side (RvS)

1. Make the outer fabric

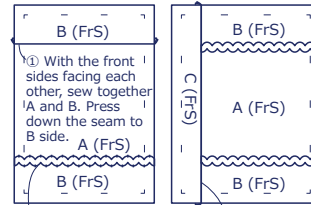

② Place the rickrack tape over ①'s stitch line and baste.

• Make two pieces.

2. Make the lining fabric

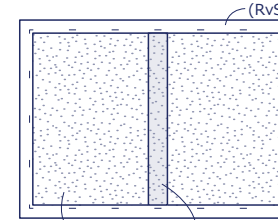

① Adhere light weight fusible interfacing.

② Adhere stiff fusible interfacing in the center.

4. Make the pen holder

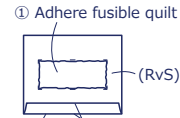

① Adhere fusible quilt batting.

② Fold the seam.

③ Fold the seam.

④ Sew.

3. Make the pocket

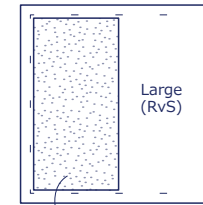

① Adhere light weight fusible interfacing on one side.

Center

6. Attach the zipper

Align the edge of the zipper with the edge of the bias binding strip.

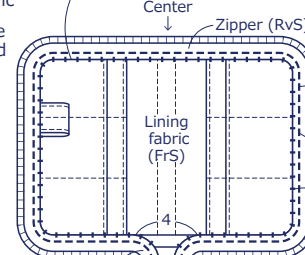

① With the front sides facing each other, layer the center of the zipper and center of the top end of the lining fabric. Sew together using half-backstitch.

② Secure the edges with blind stitches.

④ Fold the fusible quilt batting in half. Cover the end of the zipper and sew.

③ Following the previous steps ① and ②, make the small pocket.

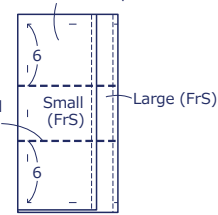

④ Layer ② and ③ and sew the partitions.

• Repeat the process on the opposite side.

② With the front sides facing outside, fold in half and apply stitches on the pocket opening.

5. Make the main portion

① With the front sides facing outside, place the outer fabric and lining fabric together. Baste it so that outer fabric C and stiff interfacing of the lining fabric are well aligned. Apply concealed stitches on both sides of outer fabric C.

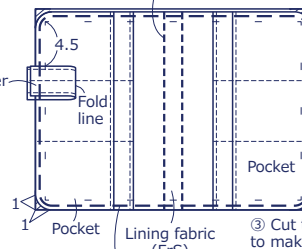

② Layer the pocket and folded pen holder and baste.

④ With the front sides facing each other, make a loop (86cm) of bias binding strip.

③ Cut the corner to make it round.

Bias binding strip (RvS)

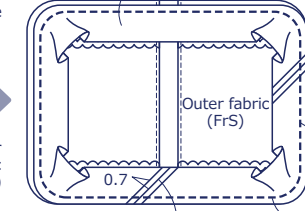

④ With the front sides facing each other, make a loop (86cm) of bias binding strip.

⑤ With the front sides facing each other, sew together the outer fabric and piece from ④.

⑦ Fold the bias binding strip in four and secure with blind stitches.

⑥ Cut off the excess seam of the pen holder.

⑧ With the front sides facing each other, fold in half and sew both sides.

⑨ Turn the tab fabric inside out. Cover over ④ and attach with blind stitches.

⑩ Fold the top and bottom ends of the tab.

⑪ Attach with blind stitches.

⑫ Attach with blind stitches.

⑬ Attach with blind stitches.

⑭ Attach with blind stitches.

⑮ Attach with blind stitches.

⑯ Attach with blind stitches.

⑰ Attach with blind stitches.

⑱ Attach with blind stitches.

Large (FrS)

Small (FrS)

Large (FrS)

Small (FrS)

Large (FrS)

Small (FrS)

Large (FrS)

Small (FrS)

Large (FrS)

Small (FrS)

Large (FrS)

Small (FrS)

Large (FrS)

Small (FrS)

Large (FrS)

Small (FrS)

Large (FrS)

Small (FrS)

Large (FrS)

Small (FrS)

Large (FrS)

Small (FrS)

Large (FrS)

Small (FrS)

Large (FrS)

Small (FrS)

Large (FrS)

Small (FrS)

Large (FrS)

Small (FrS)

Large (FrS)

Small (FrS)