



Three Piece Set for Schools

Design & work: Kokka Fabric

Size: Lesson Bag

about 28cm (l) x about 40cm (w)
about 4cm (d) (Handles excluded)

Shoe Case

about 28cm (l) x about 23cm (w)
about 4cm (d) (Handles excluded)

Gym Clothes Bag

about 35cm (l) x about 30cm (w)

Materials

- Outer fabric A: about 110cm wide x 80cm
- Outer fabric B: about 110cm wide x 30cm
- Lining fabric: about 110cm wide x 70cm
- Fusible interfacing (medium weight): about 90cm wide x 70cm
- Flat tape: 25mm wide x 100cm
- D Ring: 25mm wide x One piece
- Round Cord (medium): 150cm

Fabric shown for this sample: YPA-39030-2B

Pattern

Unit: cm. [] : Seam allowance.

Add 1cm seam unless otherwise specified when cutting the fabric.

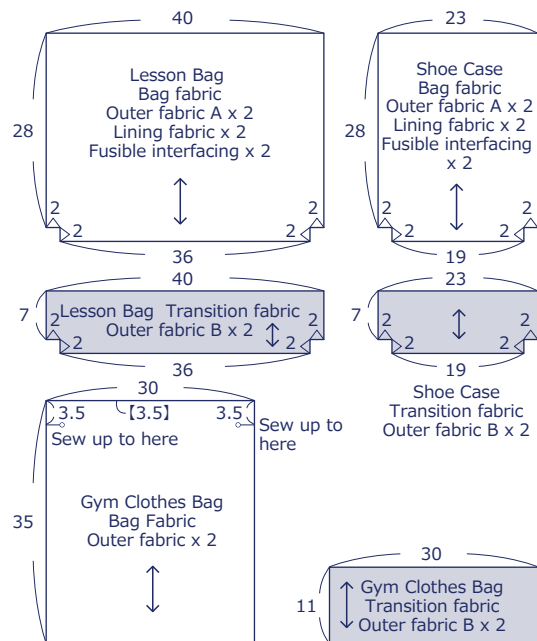

※ Adhere fusible interfacing on the back of the outer bag fabrics for the lesson bag and shoe case.

have fun with KOKKA fabric! produced by KOKKA

kokka-fabric.com

The craft projects and works featured in kokka-fabric.com are strictly for personal use and enjoyment. Please refrain from selling handmade items using the same exact design (including the pieces made in different fabrics) featured in kokka-fabric.com.

Instructions Front Side - (FrS), Reverse Side - (RvS)

1. Fold the seam of the transition fabric. Layer it over the outer bag fabric and apply stitches

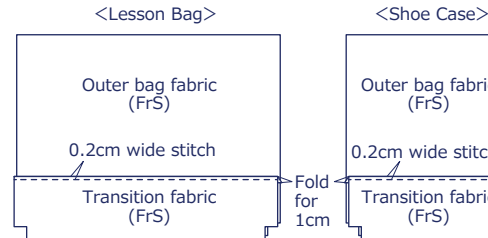

※ Repeat the same process on the other set.

2. Baste the flat tape on the outer bag fabric

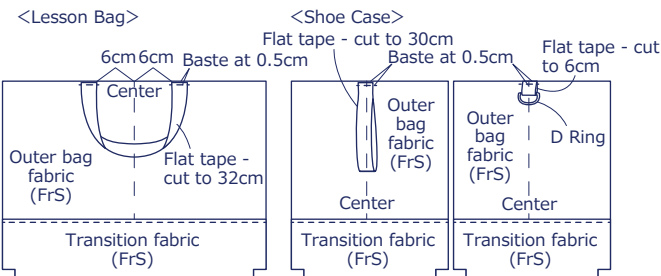

※ Baste the tape on the other set.

3. With the front sides facing each other, sew together the bag fabrics at the side, bottom and gusset

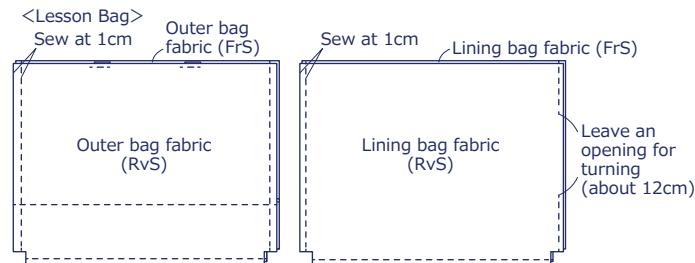

<How to sew the gusset>

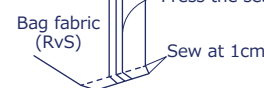

※ Repeat the same process for the shoe case.

4. With the front sides facing each other, sew together the outer bag and lining bag fabrics at the top opening. Turn it inside out and apply stitches around the opening to finish

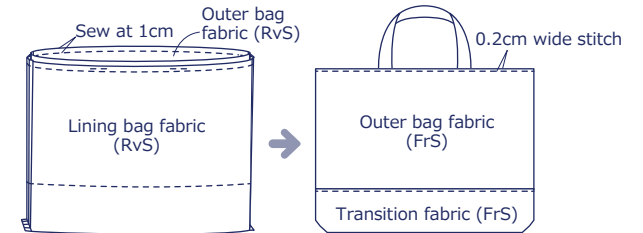

※ Close the opening for turning. ※ Repeat the same process for the shoe case.

5. Piece together the gym clothes bag's transition fabric and bag fabric. With the front sides facing each other, sew together the pieces at the side and bottom

Fold the seam of the transition fabric and layer it over the bag fabric. Apply stitches.

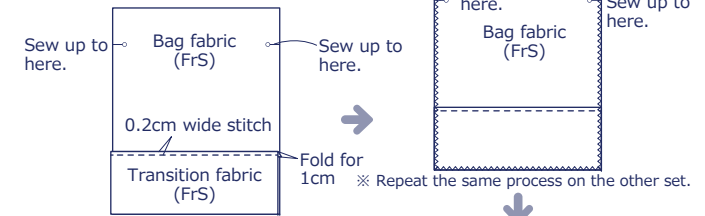

※ Repeat the same process on the other set.

6. Sew the side opening and top opening

Press the seam open on the side opening and apply stitches.

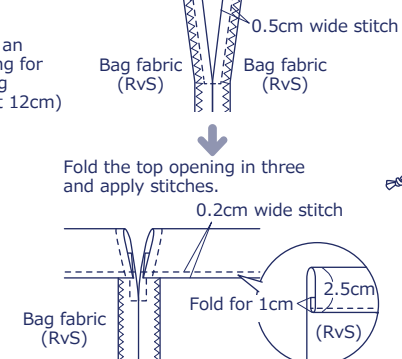

7. Turn the bag inside out and insert the cord to finish

